

Multi-Band Omni(Pole) Antenna

824~894, 1710~2170 MHz / 2 dBi, 2dBi

CP-ST-22

i. Electrical Specification

Frequency Range		824~894 MHz	1710~2170 MHz
Polarization		Vertical	
Band Width		70 MHz	425 MHz
Gain		≥ 2 dBi	≥ 2 dBi
Beam width	Horizontal	360°	
	Vertical	≥ 30°	
F-B ratio		-	-
IMD (3rd) @ 2 x 37 dBm		-140 dBc	
IMD (5rd) @ 2 x 37 dBm		-150 dBc	
VSWR		≤ 1 : 1.8	≤ 1 : 1.8
Impedance		50 Ω	
Maximum input power		50 W	



ii. Mechanical Specification

Radom Dimension (D x H)	Ø20 x 215 mm
Weight (Include bracket)	≤ 500g
Connector Type	N – Female
Withstand Wind Pressure	60 m/sec
Radome Material	FRP
Radome Color	White
Temperature	-40 °C ~ 70 °C
Packing Size (H x W x D)	-
Packing Weight	-

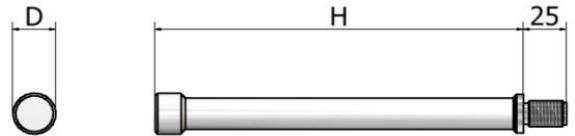

iii. Radiation Pattern

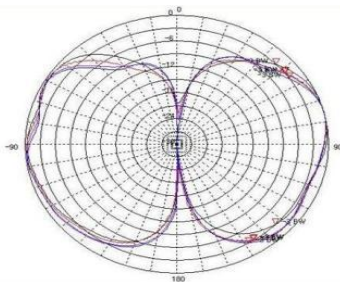

Low Band

Vertical Pattern

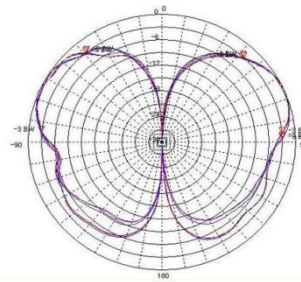

High Band